

DETAIL LEGEND:

- ① HUNTER DECODER (ICD-600) PER PLAN
- ② HUNTER DECODER STAKE (DECRSTAKE-10) DRIVEN INTO VALVE BOX BASE GRAVEL/SOIL. SECURE DECODER TO STAKE WITH BOTTOM OF DECODER FACING UP AND FASTENED TO STAKE USING TWO (2) PROVIDED ZIP TIES
- ③ INCOMING HUNTER JACKETED IDWIRE PATH PER PLAN WITH 36-IN [1m] LOOP OF SLACK WIRE, MEASURED FROM TOP OF VALVE BOX, NEATLY COILED INSIDE VALVE BOX
- ④ RED AND BLUE WIRES FROM DECODER TO IDWIRE SPLICES
- ⑤ BARE COPPER GROUND WIRE FROM DECODER TO GROUNDING DEVICE, ROD OR PLATE, SEE PLAN FOR GROUND LOCATIONS AND TYPE
- ⑥ STATION WIRE FROM DECODER OUTPUT TO VALVE SOLENOID WIRES
- ⑦ IDWIRE PATH SPLICE WITH DECODER OUTPUT USING 3M DBRY/6 INSTALLED PER MANUFACTURERS INSTRUCTIONS
- ⑧ VALVE SOLENOID WIRE SPLICE WITH DECODER OUTPUT USING 3M DBRY/6 INSTALLED PER MANUFACTURERS INSTRUCTIONS
- ⑨ VALVE SOLENOID WIRE WITH 18-IN [45cm] COIL TO SPLICE WITH DECODER OUTPUT
- ⑩ OUTGOING HUNTER JACKETED IDWIRE PATH PER PLAN WITH 36-IN [1m] LOOP OF SLACK WIRE, MEASURED FROM TOP OF VALVE BOX, NEATLY COILED INSIDE VALVE BOX
- ⑪ IRRIGATION VALVE, VALVE BOX, AND RELATED ITEMS PER IRRIGATION PLAN AND DETAILS

DETAIL NOTES:

- A. CONTRACTOR SHALL INDICATE ASSOCIATED VALVE NUMBER(S) ON MANUFACTURER PROVIDED LABEL ON DECODER WITH PERMANENT MARKER
- B. CONTRACTOR SHALL LOCATE SPLICE WITH IDWIRE AND DECODER OUTPUT IN THE MIDDLE OF 36-IN[1m] ID WIRE LOOP IN VALVE BOX
- C. CONTRACTOR SHALL CONNECT BARE COPPER GROUND WIRE FROM DECODER OUTPUT TO GROUND DEVICE WIRE USING ERICO PG11L KIT PER MANUFACTURES INSTRUCTIONS
- D. EARTH GROUND TO BE A MINIMUM OF 8 FEET AWAY FROM DECODER AND AT A RIGHT ANGLE TO THE TWO WIRE PATH
- E. GROUNDING SHALL BE INSTALLED AT A MINIMUM OF EVERY 12TH DECODER OR 1,000', WHICHEVER OCCURS FIRST

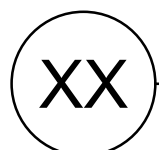
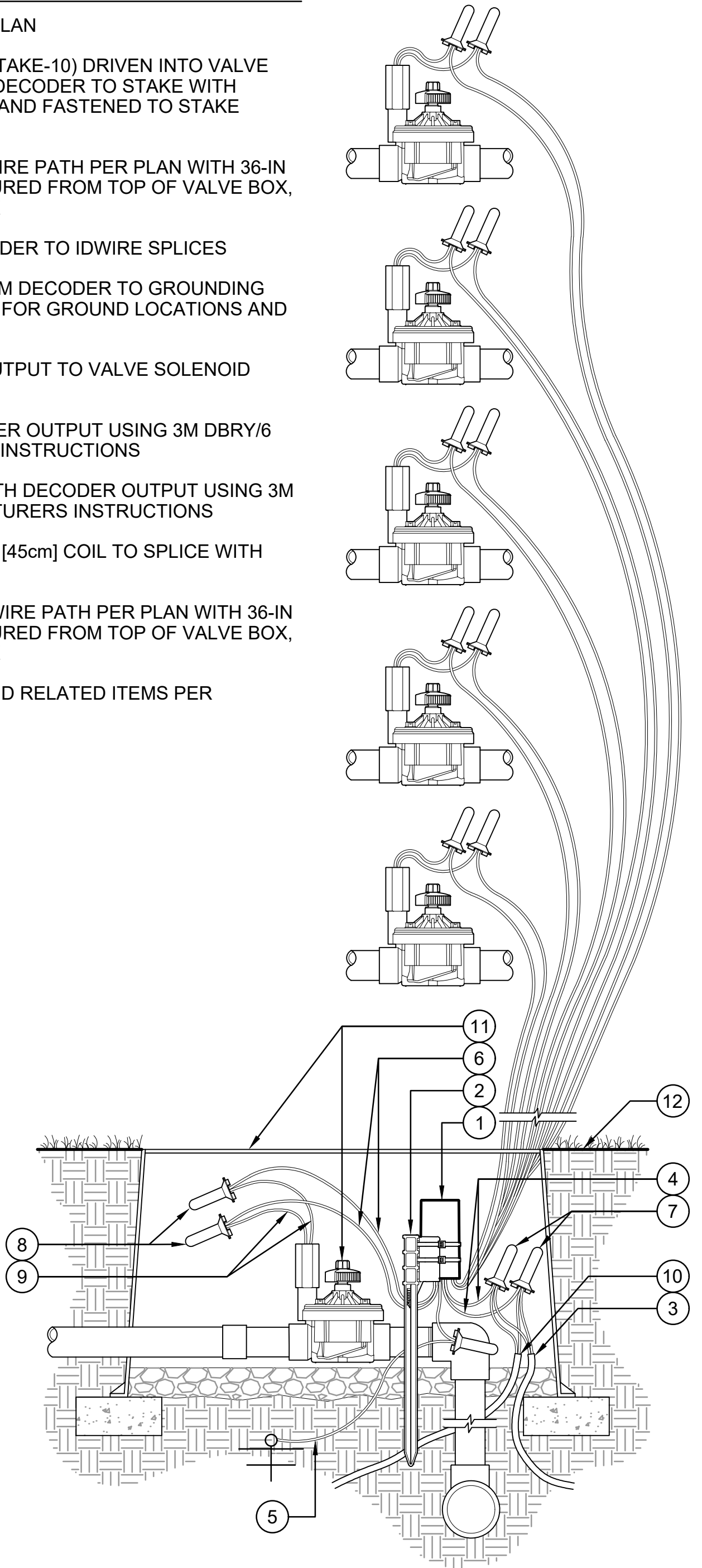

ICD-600 DECODER

Hunter® C.ICD.06

NOT TO SCALE

REV: 2021-05-18